

TECKENTRUP | HOME



# TECKENTRUP 62 SWING SECURE.

The secure & stylish swing garage door for your home.



**TECKENTRUP**  
DOOR SOLUTIONS

# STYLISH, SECURE A CLASSIC, UPDATED

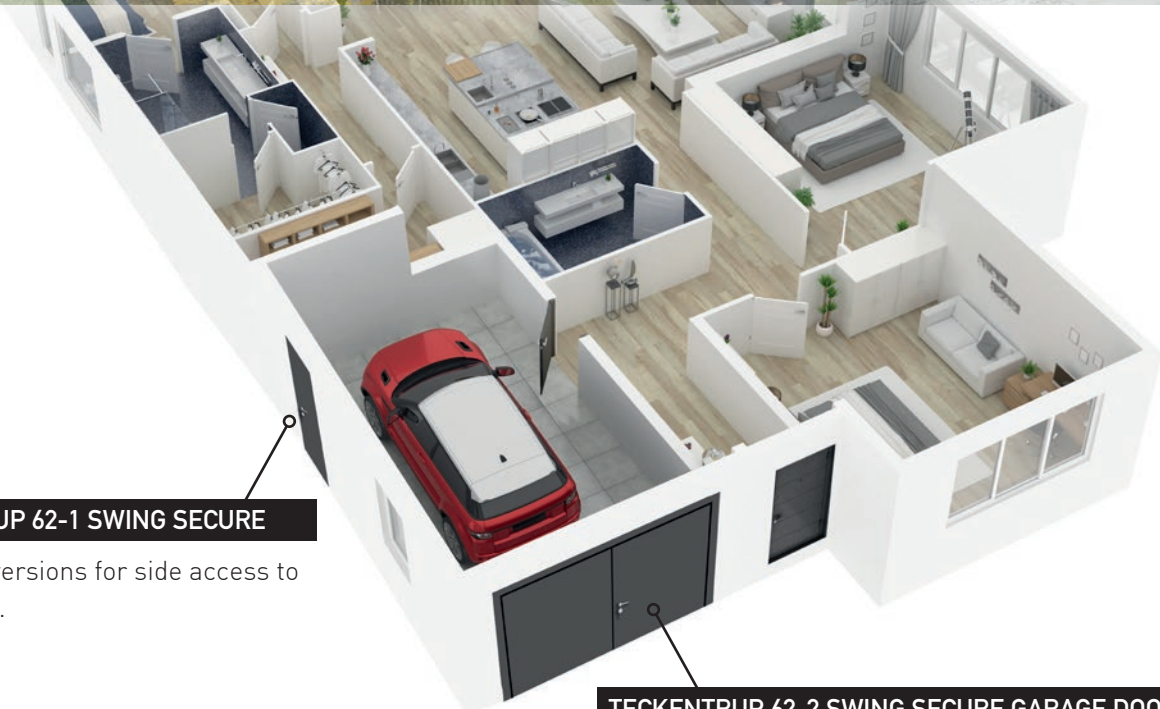

## TECKENTRUP 62-1 SWING SECURE

Single leaf versions for side access to your garage.

## TECKENTRUP 62-2 SWING SECURE GARAGE DOOR

Double leaf versions provide easy access and performance comparable to your front door.



Our doors are independently tested and certified to EN14351-1 and all current safety legislation and carry a CE mark.

#### A NEW AND SECURE LOOK FOR GARAGES

The main entrance doors to homes are becoming more attractive and high performance. Hinged swing garage doors, whilst still a popular, are limited in choice and performance.

The Teckentrup 62 Swing Secure brings crisp aesthetics and comparable performance to the main entrance door; Thermal Transmittance, Resistance to Windload, Watertightness, Air Permeability and Operating Forces are all certified in these high performance doors.

Add to this, the option of certified security to the Secured by Design Police Preferred Specification, and Teckentrup 62 Swing Secure garage doors are a classic, updated for today's homes. The superb build quality of the double leaf doors is complemented by matching single leaf doors for side or rear access to your garage space.

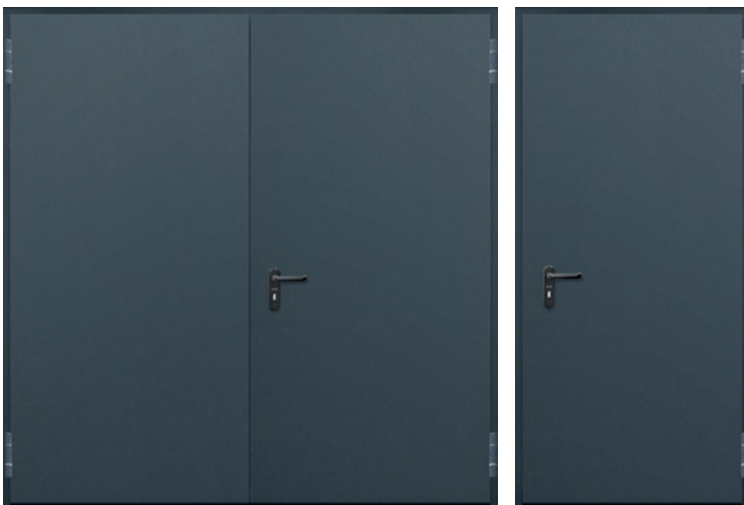

Secured by Design



Police Preferred Specification

**TECKENTRUP**  
DOOR SOLUTIONS

# STYLE YOUR DOOR



Lever Handle



1200mm 'D' Handle



1200mm 'D' Handle Pair



## HANDLES

A black lever handle and security keyed cylinder is the standard configuration for all doors.

Stainless steel is available and an option - see image on page 6.

Stainless steel pull handles in two lengths can also be added in singles or pairs to add a striking contemporary look to your door.



1500mm 'D' Handle



1500mm 'D' Handle Pair



**Colours**

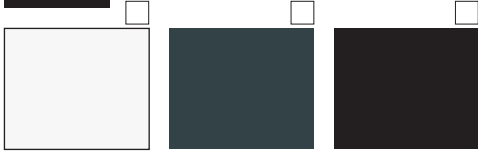

White  
RAL 9016

Anthracite Grey  
RAL 7016

Jet Black  
RAL 9005



Doors can also be coloured to any RAL shade.

**HINGE OPTION**

KO hinges are supplied as standard and are matched to the door colour.

Stainless steel hinges are available as an option.

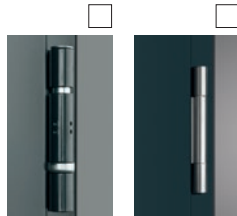

KO Hinge

Stainless Steel Hinge

**SECURITY OPTIONS**

Add certified security to The Secured by Design Police Preferred Specification.



**HIGH GRADE WINDOW OPTIONS**

All window units are double glazed and available with clear glazing for vision or frosted glazing to allow light in with privacy.



Windows are available with colour matched inserts or with a stainless steel surround.

Glazing sizes:  
190mm x 1360mm  
545mm x 354mm  
270mm x 270mm  
300mm diameter

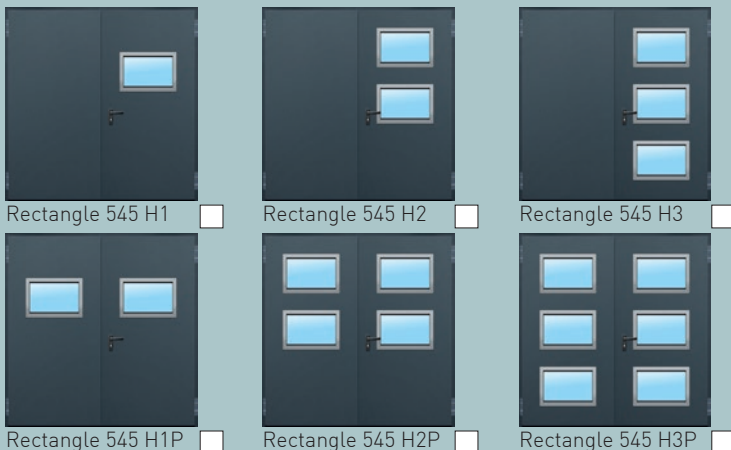

Rectangle 545 H1

Rectangle 545 H2

Rectangle 545 H3

Rectangle 545 H1P

Rectangle 545 H2P

Rectangle 545 H3P

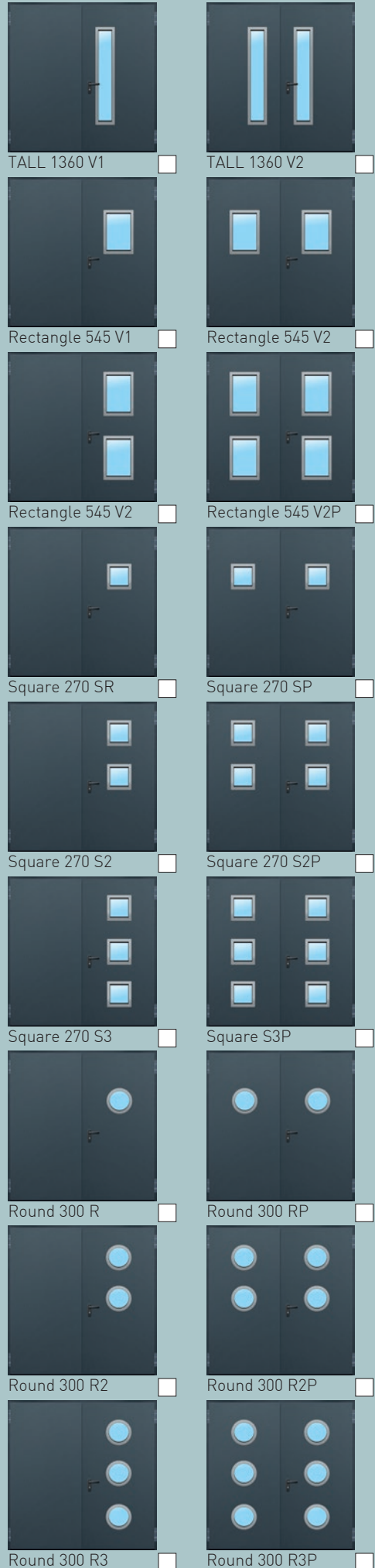

TALL 1360 V1

TALL 1360 V2

Rectangle 545 V1

Rectangle 545 V2

Rectangle 545 V2

Rectangle 545 V2P

Square 270 SR

Square 270 SP

Square 270 S2

Square 270 S2P

Square 270 S3

Square S3P

Round 300 R

Round 300 RP

Round 300 R2

Round 300 R2P

Round 300 R3

Round 300 R3P

# HIGH QUALITY BUILT TO LAST

U VALUE 1.4 Wm<sup>2</sup>K\*

The U value of the door confirms its insulation capability. The value is for a complete door with frame and is exceptionally low (which is good!).

Image shows the stainless steel handle option.

\*U value includes a 3mm clearance gap under the door.



## AUTOMATIC QUALITY

Every Teckentrup 62 Swing Secure is made to order in our automated production facility that operates to quality procedures audited to BS EN ISO 9001: 2008. We care about the environment too - this is why all of our products are certified in accordance with the Environmental Product Declaration (EPD).



## CERTIFIED PERFORMANCE

The door and frame are CE marked and have been independently tested to have the following impressive characteristics:

Insulation (Thermal Transmittance)	EN 13241-1 B: 1.4 Wm <sup>2</sup> K
Resistance to Windload	EN 12424:Class 2
Watertightness	EN 12425:Class 2
Air Permeability	EN 12426:Class 2
Operating Forces	EN 12604: 150N
Operating Cycles	EN1191 C5 (200,000)
Security (optional)	EN1627/30 RC2 or Secured by Design Police Preferred Specification



**SECURITY**



Each door is supplied with a pair of Security keys. Security keys add extra security by preventing unauthorised copying. They cannot be cut by anyone other than the issuer of the key - Teckentrup.



The inactive leaf is secured with flush bolts to the top and bottom of the leaf.



Doors are available with independently certified security to the Secured by Design Police Preferred Standard.

**THRESHOLD**

For improved weather protection, a stepped aluminium threshold with a bulb weather strip is provided. The door leaves close against the raised weather strip creating an improved barrier to dust and debris. The threshold is DDA compliant for wheelchair access.



**HOLD OPEN STAYS**

Double doors have foot activated stays to hold the door in the open position.



**Please note - stays are not designed for high wind applications.**

**RAIN-GUARD**

An anodised aluminium rain-guard is supplied with all doors help limit water ingress at the top of the door.

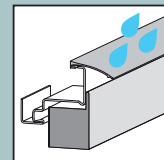

**FRAMES**

Every door is supplied with a frame. A 'block frame' is the standard option with two variants, the 'Corner Frame' and the 'Corner Counter Frame'. Each frame is made from heavy gauge corrosion protected steel and provides a stable platform for the door to operate.



**BLOCK FRAME**

The block frame is the standard frame design. Provided with Rockwool filling.



**CORNER FRAME**

The innovative corner frame wraps around the front corner of the garage opening providing a neat edge. Its slim profile also gives an additional 56 mm drive through width compared to a block frame.

Requires back-filling with a foam sealant.

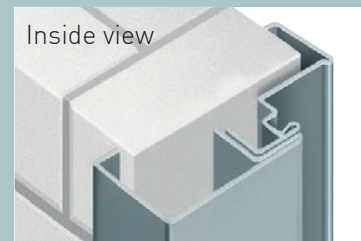

**CORNER COUNTER FRAME**

The counter frame wraps around the front and back corner of the garage opening providing a neat edge. Its slim profile also gives an additional 56mm drive through width compared to a block frame.

Requires back-filling with a foam sealant.

**FB PROFILE OPTION**

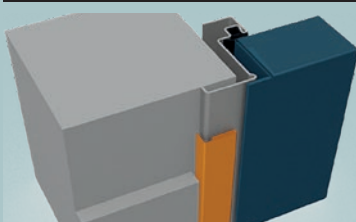

The FB Frame option allows for a flush finish between door lip, frame and wall finish on Corner and Corner Counter frames in new openings that are rendered after the door is installed. The FB option also provides a flush finish on block frames that are fixed at the front edge of the garage opening reveal.